

Boundary dimensions (mm)							Bearing No	(Ref.) ISO355 Dimension series	Basic dynamic load rating Cr (N)	Basic static load rating Cor (N)	Limiting speed (min-1)		Abutment and fillet dimensions (mm)								Load center (mm) a (1)	Constant e	Axial load factor		Mass(kg) Reference	Bearing No
d	D	T	B	C	Cone	Cup					Grease lubrication	Oil lubrication	da (min)	db (max)	Da (min)	Db (min)	S1 (min)	S2 (min)	Cone	Cup			Y1	Y0		
					r (min)														ra (max)							
15	35	11.75	11	10	0.6	0.6	E30202J	-	15800	14500	12000	16000	19.5	20	29	33	2	1.7	0.6	0.6	3.4	0.32	1.88	1.04	0.054	E30202J
17	40	13.25	12	11	1	1	E30203J	2DB	20800	20700	10000	14000	22.5	23	33	37	2	2	1	1	3.2	0.35	1.74	0.96	0.081	E30203J
20	47	15.25	14	12	1	1	E30204J	2DB	27000	27200	8700	12000	25.5	27	39	44	2	3	1	1	3.5	0.35	1.74	0.95	0.127	E30204J
25	52	16.25	15	13	1	1	E30205J	3CC	31500	33700	7500	10000	30.5	31	44	48	2	3	1	1	3.3	0.37	1.60	0.88	0.156	E30205J
30	62	17.25	16	14	1	1	E30206J	3DB	41500	44800	6500	8700	35.5	37	53	57	2	3	1	1	3.1	0.37	1.60	0.88	0.236	E30206J
35	72	18.25	17	15	1.5	1.5	E30207J	3DB	55100	60900	5600	7400	43.5	44	62	67	3	3	1.5	1.5	2.9	0.37	1.60	0.88	0.344	E30207J
40	80	19.75	18	16	1.5	1.5	E30208J	3DB	62900	69200	5000	6700	48.5	49	69	75	3	3.5	1.5	1.5	2.7	0.37	1.60	0.88	0.434	E30208J
45	85	20.75	19	16	1.5	1.5	E30209J	3DB	67200	77400	4600	6100	53.5	54	74	80	3	4.5	1.5	1.5	1.8	0.40	1.48	0.81	0.502	E30209J
50	90	21.75	20	17	1.5	1.5	E30210J	3DB	76500	91700	4300	5700	58.5	58	79	85	3	4.5	1.5	1.5	1.65	0.42	1.43	0.79	0.566	E30210J
55	100	22.75	21	18	2	1.5	E30211J	3DB	94600	113000	3900	5200	65	64	88	94	4	4.5	2	1.5	2	0.40	1.48	0.81	0.732	E30211J
60	110	23.75	22	19	2	1.5	E30212J	3EB	106000	127000	3500	4700	70	70	96	103	4	4.5	2	1.5	1.8	0.40	1.48	0.81	0.945	E30212J
65	120	24.75	23	20	2	1.5	E30213J	3EB	128000	156000	3200	4300	75	77	106	113	4	4.5	2	1.5	0.6	0.40	1.48	0.81	1.18	E30213J
70	125	26.25	24	21	2	1.5	E30214J	3EB	138000	173000	3100	4100	80	81	110	118	4	5	2	1.5	0.3	0.42	1.43	0.79	1.32	E30214J
75	130	27.25	25	25	2	1.5	E30215J	4DB	142000	181000	2900	3900	85	86	115	124	4	5	2	1.5	-0.3	0.44	1.38	0.76	1.42	E30215J
80	140	28.25	26	22	2.5	2	E30216J	3EB	161000	202000	2700	3600	92	91	124	132	4	6	2	2	-0.3	0.42	1.43	0.79	1.72	E30216J
85	150	30.5	28	24	2.5	2	E30217J	3EB	182000	231000	2500	3400	97	97	132	141	5	6.5	2	2	0.1	0.42	1.43	0.79	2.17	E30217J
90	160	32.5	30	26	2.5	2	E30218J	3FB	204000	261000	2400	3200	102	103	140	150	5	6.5	2	2	-0.1	0.42	1.43	0.79	2.65	E30218J
95	170	34.5	32	27	3	2.5	E30219J	3FB	231000	299000	2200	3000	109	110	149	159	5	7.5	2.5	2	-0.4	0.42	1.43	0.79	3.20	E30219J
100	180	37	34	29	3	2.5	E30220J	3FB	258000	338000	2100	2800	114	116	157	168	5	8	2.5	2	0.2	0.42	1.43	0.79	3.83	E30220J
105	190	39	36	30	3	2.5	E30221J	-	288000	380000	2000	2600	119	122	165	178	6	9	2.5	2	0.0	0.42	1.43	0.79	4.49	E30211L
110	200	41	38	32	3	2.5	E30222J	3FB	324000	343000	1900	2500	124	129	174	188	6	9	2.5	2	0.2	0.42	1.43	0.79	5.33	E30222J
120	215	43.5	40	34	3	2.5	E30224J	4FE	347000	473000	1700	2300	134	140	187	203	6	9.5	2.5	2	-0.7	0.44	1.38	0.76	6.36	E30224J
130	230	43.75	40	34	4	3	E30226J	4FB	377000	511000	1600	2100	148	152	203	218	7	9.5	3	2.5	-2.7	0.44	1.38	0.76	7.24	E30226J
140	250	45.75	42	36	4	3	E30228J	-	405000	538000	1500	1900	158	163	219	237	9	9.5	3	2.5	-3.4	0.43	1.39	0.77	8.9	E30228J
150	270	49	45	38	4	3	E30230J	-	466000	625000	1300	1800	168	175	234	255	9	11	3	2.5	-2.7	0.43	1.39	0.77	10.9	E30230J

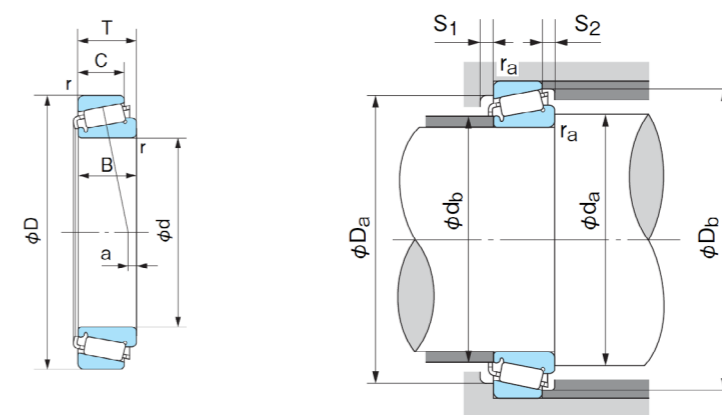

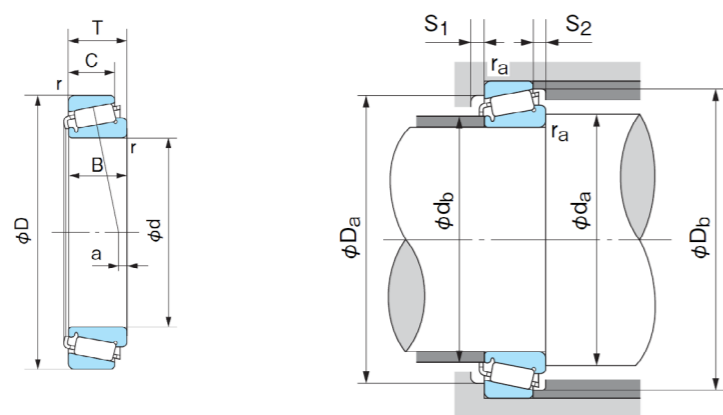

Boundary dimensions (mm)							Bearing No	(Ref.) ISO355 Dimension series	Basic dynamic load rating Cr (N)	Basic static load rating Cor (N)	Limiting speed (min-1)		Abutment and fillet dimensions (mm)						Load center (mm) a (1)	Constant e	Axial load factor		Mass(kg) Reference	Bearing No		
d	D	T	B	C	Cone	Cup					Grease lubrication	Oil lubrication	da (min)	db (max)	Da (min)	Db (min)	S1 (min)	S2 (min)			Cone	Cup			Y1	Y0
r (min)						ra (max)																				
20	42	15	15	12	0.6	0.6	E32004J	3CC	27300	31500	9300	13000	24.5	25	35	39	3	3	0.6	0.6	4.5	0.37	1.6	0.88	0.102	E32004J
25	47	15	15	11.5	0.6	0.6	E32005J	4CC	30200	37700	8300	11000	29.5	30	40	44	3	3.5	0.6	0.6	3.2	0.43	1.39	0.77	0.118	E32005J
26	47	15	15	11.5	0.6	0.6	E32005JS	4CC	30200	37700	8300	11000	29.5	30	40	44	3	3.5	0.6	0.6	3.2	0.43	1.39	0.77	0.118	E32005JS
30	55	17	17	13	1	1	E32006J	4CC	38200	48000	7000	9400	35.5	35	47	52	3	4	1	1	3.4	0.43	1.39	0.77	0.177	E32006J
35	62	18	18	14	1	1	E32007J	4CC	45500	59400	6200	8200	40.5	40	54	59	4	4	1	1	2.9	0.45	1.32	0.73	0.231	E32007J
40	68	19	19	14.5	1	1	E32008J	3CD	53500	71400	5600	7400	45.5	46	60	65	4	4.5	1	1	3.9	0.38	1.58	0.87	0.282	E32008J
45	75	20	20	15.5	1	1	E32009J	3CC	62800	86500	5000	6600	50.5	51	67	72	4	4.5	1	1	3.5	0.39	1.53	0.84	0.354	E32009J
50	80	20	20	15.5	1	1	E32010J	3CC	65700	94500	4600	6100	55.5	56	72	77	4	4.5	1	1	2.3	0.42	1.42	0.78	0.389	E32010J
50	80	20	20	15.5	-	-	E32010JA1*	3CC	65700	94500	4600	6100	-	-	-	-	-	-	-	-	2.3	0.42	1.42	0.78	0.389	E32010JA1
55	90	23	23	17.5	1.5	1.5	E32011J	3CC	84600	121000	4100	5500	63.5	63	81	86	4	5.5	1.5	1.5	3.2	0.41	1.48	0.81	0.569	E32011J
60	95	23	23	17.5	1.5	1.5	E32012J	4CC	86100	127000	3900	5200	68.5	67	85	91	4	5.5	1.5	1.5	2	0.43	1.39	0.77	0.621	E32012J
65	100	23	23	17.5	1.5	1.5	E32013J	4CC	90000	137000	3600	4800	73.5	72	90	97	4	5.5	1.5	1.5	0.5	0.46	1.31	0.72	0.664	E32013J
70	110	25	25	19	1.5	1.5	E32014J	4CC	108000	163000	3300	4400	78.5	78	98	105	5	6	1.5	1.5	1.4	0.43	1.38	0.76	0.884	E32014J
75	115	25	25	19	1.5	1.5	E32015J	4CC	110000	169000	3100	4200	83.5	83	103	110	5	6	1.5	1.5	-0.1	0.46	1.31	0.72	0.93	E32015J
80	125	29	29	22	1.5	1.5	E32016J	3CC	147000	225000	2900	3900	88.5	89	112	120	6	7	1.5	1.5	2.3	0.42	1.42	0.78	1.32	E32016J
85	130	29	29	22	1.5	1.5	E32017J	4CC	150000	234000	2800	3700	93.5	94	117	125	6	7	1.5	1.5	1	0.44	1.36	0.75	1.38	E32017J
90	140	32	32	24	2	1.5	E32018J	3CC	178000	276000	2600	3500	100	100	125	134	6	8	2	1.5	2.2	0.42	1.42	0.78	1.8	E32018J
95	145	32	32	24	2	1.5	E32019J	4CC	182000	287000	2500	3300	105	105	130	140	6	8	2	1.5	0.8	0.44	1.36	0.75	1.88	E32019J
100	150	32	32	24	2	1.5	E32020J	4CC	185000	298000	2400	3200	110	109	134	144	6	8	2	1.5	-0.6	0.46	1.31	0.72	1.95	E32020J
105	160	35	35	26	2.5	2	E32021J	4DC	215000	344000	2200	3000	117	116	143	154	6	9	2	2	0.5	0.44	1.35	0.74	2.45	E32021J
110	170	38	38	29	2.5	2	E32022J	4DC	248000	395000	2100	2800	122	122	152	163	7	9	2	2	1.9	0.43	1.39	0.77	3.12	E32022J
120	180	38	38	29	2.5	2	E32024J	4DC	258000	427000	2000	2600	132	131	161	173	7	9	2	2	-0.8	0.46	1.31	0.72	3.34	E32024J
130	200	45	45	34	2.5	2	E32026J	4EC	340000	563000	1800	2300	142	144	178	192	8	11	2	2	2.1	0.43	1.38	0.76	5.04	E32026J
140	210	45	45	34	2.5	2	E32028J	4DC	346000	585000	1700	2200	152	153	187	202	8	11	2	2	-0.6	0.46	1.31	0.72	5.28	E32028J
150	225	48	48	36	2.5	2	E32030J	4EC	391000	668000	1500	2000	164	164	200	216	8	12	2.5	2	-0.8	0.46	1.31	0.72	6.41	E32030J
160	240	51	51	38	3	2.5	E32032J	4EC	440000	758000	1400	1900	174	175	213	231	8	13	2.5	2	-1.1	0.46	1.31	0.72	7.75	E32032J
170	260	57	57	43	3	2.5	E32034J	4EC	526000	905000	1300	1700	184	187	230	249	10	14	2.5	2	1.2	0.44	1.35	0.74	10.5	E32034J
180	280	64	64	48	3	2.5	E32036J	4EC	644000	1100000	1200	1600	194	199	247	268	10	16	2.5	2	4.5	0.42	1.42	0.78	14.1	E32036J
190	290	64	64	48	3	2.5	E32038J	4FD	654000	1170000	1100	1500	204	209	257	279	10	16	2.5	2	1.1	0.44	1.36	0.75	14.7	E32038J

\* Tapered Roller (Automotive).

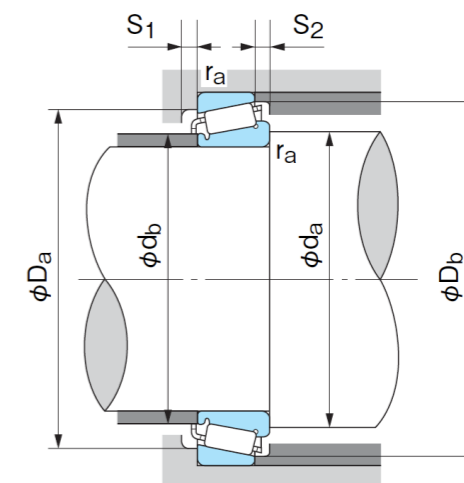
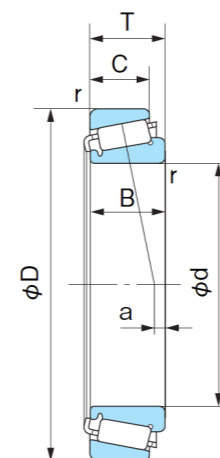
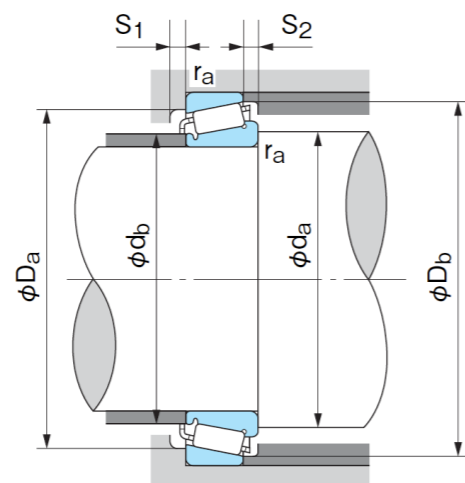
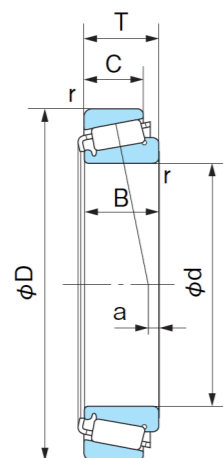

Boundary dimensions (mm)							Bearing No.	(Ref.) ISO355 Dimension series	Basic dynamic load rating Cr (N)	Basic static load rating Cor (N)	Limiting speed (min <sup>-1</sup> )		Abutment and fillet dimensions (mm)						Load center (mm) a (1)	Constant e	Axial load factor		Mass(kg) Reference	Bearing No.		
d	D	T	B	C	Cone r (min)	Cup r (min)					Grease lubrication	Oil lubrication	da (min)	db (max)	Da (min)	Db (min)	S1 (min)	S2 (min)			Cone ra (max)	Cup ra (max)			Y1	Y0
20	47	19.25	18	15	1	1	E32204J	2DD	32500	34800	8700	12000	25.5	27	39	43	2	4	1	1	6.2	0.35	1.73	0.95	0.156	E32204J
25	52	19.25	18	16	1	1	E32205J	2CD	39800	44800	7900	11000	30.5	31	43	48	2	4	1	1	5.7	0.36	1.67	0.92	0.188	E32205J
30	62	21.25	20	17	1	1	E32206J	3DC	50700	57900	6500	8700	35.5	37	52	58	2	4	1	1	5.3	0.37	1.60	0.88	0.292	E32206J
35	72	24.25	23	19	1.5	1.5	E32207J	3DC	69600	82400	5600	7500	43.5	43	61	67	3	5	1.5	1.5	6.0	0.37	1.60	0.88	0.453	E32207J
40	80	24.75	23	19	1.5	1.5	E32208J	3DC	77700	90800	5000	6600	48.5	48	68	75	3	5.5	1.5	1.5	5.3	0.37	1.60	0.88	0.554	E32208J
45	85	24.75	23	19	1.5	1.5	E32209J	3DC	78300	94100	4600	6100	53.5	53	73	81	3	5.5	1.5	1.5	3.8	0.40	1.48	0.81	0.587	E32209J
50	90	24.75	23	19	1.5	1.5	E32210J	3DC	85000	105000	4300	5700	58.5	58	78	85	3	5.5	1.5	1.5	4.1	0.42	1.43	0.79	0.643	E32210J
55	100	26.75	25	21	2	1.5	E32211J	3DC	107000	133000	3900	5200	65	63	87	95	4	5.5	2	1.5	3.7	0.40	1.48	0.81	0.863	E32211J
60	110	29.75	28	24	2	1.5	E32212J	3EC	132000	167000	3500	4700	70	69	95	104	4	5.5	2	1.5	4.6	0.40	1.48	0.81	1.19	E32212J
65	120	32.75	31	27	2	1.5	E32213J	3EC	157000	203000	3200	4300	75	76	104	115	4	5.5	2	1.5	6.1	0.40	1.48	0.82	1.58	E32213J
70	125	33.25	31	27	2	1.5	E32214J	3EC	169000	225000	3100	4100	80	80	108	119	4	6	2	1.5	4.0	0.42	1.43	0.79	1.71	E32214J
75	130	33.25	31	27	2	1.5	E32215J	4DC	174000	234000	2900	3900	85	85	114	123	4	6	2	1.5	3.0	0.44	1.38	0.76	1.77	E32215J
80	140	35.25	33	28	2.5	2	E32216J	3EC	203000	271000	2700	3600	92	90	122	134	4	7	2	2	3.8	0.42	1.43	0.79	2.17	E32216J
85	150	38.5	36	30	2.5	2	E32217J	3EC	232000	315000	2500	3300	97	96	130	142	5	8.5	2	2	4.3	0.42	1.43	0.79	2.8	E32217J
90	160	42.5	40	34	2.5	2	E32218J	3FC	263000	362000	2400	3200	102	102	138	152	5	8.5	2	2	5.5	0.42	1.43	0.79	3.47	E32218J
95	170	45.5	43	37	3	2.5	E32219J	3FC	311000	439000	2200	3000	109	108	145	161	5	8.5	2.5	2	6.6	0.42	1.43	0.79	4.34	E32219J
100	180	49	46	39	3	2.5	E32220J	3FC	347000	495000	2100	2800	114	114	154	171	5	10	2.5	2	6.9	0.42	1.43	0.79	5.21	E32220J
105	190	53	50	43	3	2.5	E32221J	3FC	392000	567000	2000	2700	119	120	161	180	6	10	2.5	2	8.2	0.42	1.43	0.79	6.37	E32221J
110	200	56	53	46	3	2.5	E32222J	3FC	438000	640000	1900	2500	124	126	170	190	6	10	2.5	2	9.3	0.42	1.43	0.79	7.45	E32222J
120	215	61.5	58	50	3	2.5	E32224J	4FD	470000	691000	1700	2300	134	136	181	204	7	11.5	2.5	2	9.9	0.44	1.38	0.76	9.04	E32224J
130	230	67.75	64	54	4	3	E32226J	4FD	554000	830000	1600	2200	148	146	193	219	7	13.5	3	2.5	11.7	0.44	1.38	0.76	11.5	E32226J
140	250	71.75	68	58	4	3	E32228J	4FD	636000	961000	1500	2000	158	158	210	238	9	13.5	3	2.5	11.7	0.44	1.39	0.76	14.7	E32228J
150	270	77	73	60	4	3	E32230J	4GD	704000	1070000	1300	1800	168	170	226	254	8	17	3	2.5	11.8	0.44	1.38	0.76	18.2	E32230J
160	290	84	80	67	4	3	E32232J	4GD	795000	1210000	1200	1700	178	182	242	274	10	17	3	2.5	13.7	0.44	1.38	0.76	23.2	E32232J

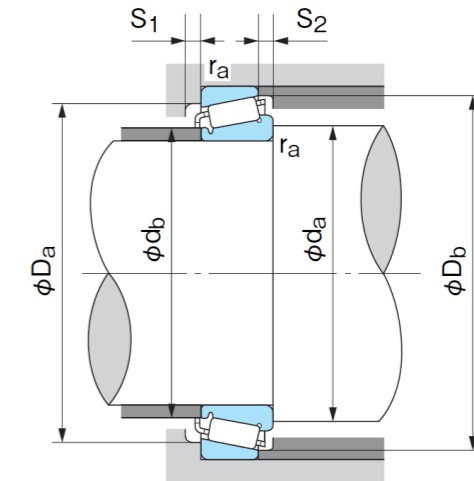
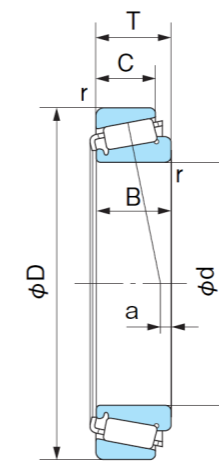
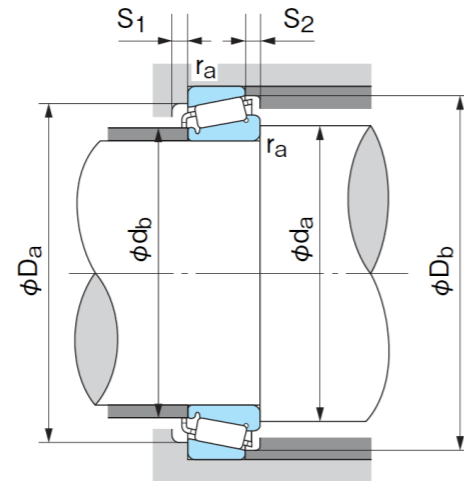
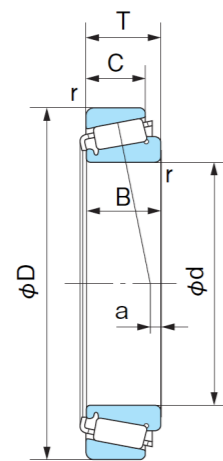

Boundary dimensions (mm)							Bearing No.	(Ref.) ISO355 Dimension series	Basic dynamic load rating Cr (N)	Basic static load rating Cor (N)	Limiting speed (min <sup>-1</sup> )		Abutment and fillet dimensions (mm)								Load center (mm) a (1)	Constant e	Axial load factor		Mass(kg) Reference	Bearing No.
d	D	T	B	C	Cone r (min)	Cup r (min)					Grease lubrication	Oil lubrication	da (min)	db (max)	Da (min)	Db (min)	S1 (min)	S2 (min)	Cone ra (max)	Cup ra (max)			Y1	Y0		
20	52	22.25	21	18	1.5	1.5	E32304J	2FD	45100	46700	8400	11000	28.5	27	43	47	3	4	1.5	1.5	7.8	0.30	2.00	1.10	0.239	E32304J
25	62	25.25	24	20	1.5	1.5	E32305J	2FD	61200	64100	6900	9100	33.5	33	52	57	3	5	1.5	1.5	8.6	0.30	2.00	1.10	0.386	E32305J
30	72	28.75	27	23	1.5	1.5	E32306J	2FD	82200	91600	5900	7900	38.5	39	59	66	3	5.5	1.5	1.5	9.8	0.31	1.90	1.05	0.588	E32306J
35	80	32.75	31	25	2	1.5	E32307J	2FE	101000	114000	5300	7000	45	44	66	74	3	7.5	2	1.5	12.2	0.31	1.90	1.05	0.776	E32307J
40	90	35.25	33	27	2	1.5	E32308J	2FD	116000	139000	4600	6200	50	50	73	82	3	8	2	1.5	10.9	0.35	1.74	0.96	1.06	E32308J
45	100	38.25	36	30	2	1.5	E32309J	2FD	146000	180000	4100	5500	55	56	82	93	3	8	2	1.5	11.4	0.35	1.74	0.96	1.43	E32309J
50	110	42.25	40	33	2.5	2	E32310J	2FD	176000	220000	3700	5000	62	62	90	102	3	9	2	2	12.9	0.35	1.74	0.96	1.89	E32310J
55	120	45.5	43	35	2.5	2	E32311J	2FD	200000	250000	3400	4500	67	68	99	111	4	10.5	2	2	13.1	0.35	1.74	0.96	2.38	E32311J
60	130	48.5	46	37	3	2.5	E32312J	2FD	221000	275000	3100	4200	74	74	107	120	4	11.5	2.5	2	16.2	0.35	1.74	0.96	2.92	E32312J
65	140	51	48	39	3	2.5	E32313J	2GD	276000	357000	2900	3900	79	80	117	130	4	12	2.5	2	16.3	0.35	1.74	0.96	3.64	E32313J
70	150	54	51	42	3	2.5	E32314J	2GD	317000	414000	2700	3600	84	86	125	140	4	12	2.5	2	16.6	0.35	1.74	0.96	4.50	E32314J
80	170	61.5	58	48	3	2.5	E32316J	2GD	378000	497000	2300	3100	94	98	142	159	4	13.5	2.5	2	19.5	0.35	1.73	0.95	6.32	E32316J
90	190	67.5	64	53	4	3	E32318J	2DG	461000	461000	2100	2800	108	108	157	177	5	14.5	3	2.5	20.9	0.35	1.74	0.96	8.61	E32318J