

## SU000 Silver Series

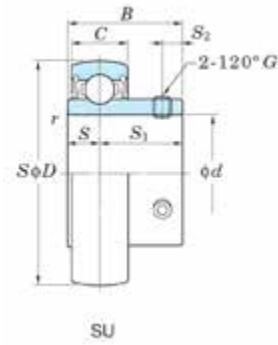

## SU000 Silver Series

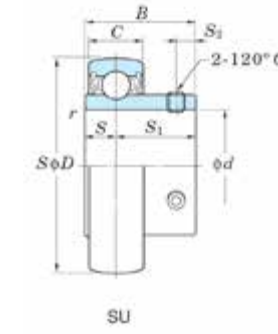

Shaft Dia		Dimensions								Basic Load ratingskN		Factor	Bearing no.	Dimensions						Set Screw Brg. Bore		Mass kg
mm	inch	D		B		C		r (min.)		Cr	COr	f 0	Standard	S		S1		S2		G		
d		mm	inch	mm	inch	mm	inch	mm	inch					mm	inch	mm	inch	mm	inch	mm	inch	
10	-	26	1.024	15	0.591	8	0.315	0.3	0.012	4.55	1.95	12.3	SU000	5	0.197	10	0.394	3	0.118	M3x0.35	-	0.024
12	-	28	1.102	15	0.591	8	0.315	0.3	0.012	5.1	2.4	13.2	SU001	5	0.197	10	0.394	3	0.118	M3x0.36	-	0.026
15	-	32	1.26	16.5	0.65	9	0.354	0.3	0.012	5.6	2.85	13.9	SU002	5.5	0.217	11	0.433	3.3	0.13	M4x0.5	-	0.038
17	-	35	1.378	17.5	0.689	10	0.394	0.3	0.012	6	3.25	14.4	SU003	6	0.236	11.5	0.453	3.3	0.13	M4x0.5	-	0.05
20	-	42	1.654	21	0.827	12	0.472	0.6	0.024	9.4	5.05	13.9	SU004	7	0.276	14	0.551	4	0.157	M5x0.5	-	0.08
25	-	47	1.85	22	0.866	12	0.472	0.6	0.024	10.1	5.85	14.5	SU005	7	0.276	15	0.591	4.5	0.177	M5x0.5	-	0.1
30	-	55	2.165	24.5	0.965	13	0.512	1	0.039	13.2	8.25	14.7	SU006	7.5	0.295	17	0.669	5.5	0.217	M5x0.5	-	0.15

## SC200 Series

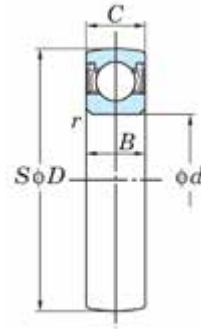

Shaft Dia.	Dimensions								Basic Load Ratings kN		Factor	Bearing No.	Mass Kg
mm	D		B		C		r (min)		Cr	COr	f 0		
d	mm	inch	mm	inch	mm	inch	mm	inch					
17	40	1.575	12	0.472	12	0.472	0.6	0.024	9.55	4.8	13.2	SC203	0.1
20	47	1.85	14	0.551	14	0.551	1	0.039	12.8	6.65	13.2	SC204	0.15
25	52	2.047	15	0.591	15	0.591	1	0.039	14	7.85	13.9	SC205	0.18
30	62	2.441	16	0.63	16	0.63	1	0.039	19.5	11.3	13.9	SC206	0.27
35	72	2.835	17	0.669	17	0.669	1.1	0.043	25.7	15.4	13.9	SC207	0.42
40	80	3.15	18	0.709	18	0.709	1.1	0.043	29.1	17.8	14	SC208	0.6