

UCX00 Series (Medium Duty)

WIR both side with Grub Screw

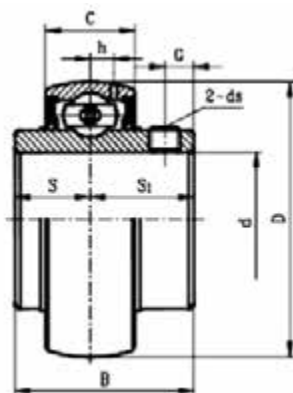

Part No.	Dimensions(mm / inch)									Basic Loads (KN)		N.W. (kg)
	d (mm)	d (inch)	D	B	C	S	S1	G	h	Cr	Cor	
UCX05	25	-	62	38.1	19	15.9	22.2	6	4.8	16.7	9.6	0.37
UCX05-16	-	1	62	38.1	19	15.9	22.2	6	4.8	16.7	9.6	0.37
UCX06	30	-	72	42.9	20	17.5	25.4	6.5	5.4	22	13.1	0.47
UCX06-20	-	1.25	72	42.9	20	17.5	25.4	6.5	5.4	22	13.1	0.47
UCX07	35	-	80	49.2	21	19	30.2	8	5.9	28	17	0.76
UCX07-20	-	1.25	80	49.2	21	19	30.2	8	5.9	28	17	0.76
UCX07-23	-	1.438	80	49.2	21	19	30.2	8	5.9	28	17	0.76
UCX08	40	-	85	49.2	22	19	30.2	8	6.1	28.1	17.5	0.81
UCX08-24	-	1.5	85	49.2	22	19	30.2	8	6.1	28.1	17.5	0.81
UCX09	45	-	90	51.6	24	19	32.6	9	6.5	30.1	19.9	0.92
UCX09-28	-	1.75	90	51.6	24	19	32.6	9	6.5	30.1	19.9	0.92
UCX10	50	-	100	55.6	25	22.2	33.4	9	7.1	37.2	25.1	1.23
UCX10-30	-	1.875	100	55.6	25	22.2	33.4	9	7.1	37.2	25.1	1.23
UCX11	55	-	110	65.1	27	25.4	39.7	10.5	7.6	41	28.3	1.74
UCX11-32	-	2	110	65.1	27	25.4	39.7	10.5	7.6	41	28.3	1.85
UCX12	60	-	120	65.1	28	25.4	39.7	12	8.5	49.2	34.4	2.03
UCX12-36	-	2.25	120	65.1	28	25.4	39.7	12	8.5	49.2	34.4	2.15
UCX13	65	-	125	74.6	29	30.2	44.4	12	-	-	-	2.33
UCX13-40	-	2.5	125	74.6	29	30.2	44.4	12	-	-	-	2.33
UCX14	70	-	130	77.8	30	33.3	44.5	12	-	-	-	2.54
UCX14-44	-	2.75	130	77.8	30	33.3	44.5	12	-	-	-	2.54
UCX15	75	-	140	82.6	32	33.3	49.3	12	-	-	-	3.20
UCX15-48	-	3	140	82.6	32	33.3	49.3	12	-	-	-	3.20
UCX16	80	-	150	85.7	-	-	-	-	-	-	-	3.90
UCX16-50	-	3.125	150	85.7	-	-	-	-	-	-	-	3.95
UCX17	85	-	160	96	-	-	-	-	-	-	-	4.60
UCX17-52	-	3.25	160	96	-	-	-	-	-	-	-	4.90
UCX18	90	-	170	104	-	-	-	-	-	-	-	6