

UK200 Series (Light Duty)

WIR both side - Tapered Bore

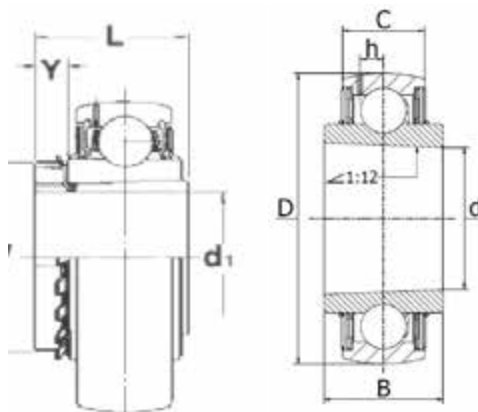

Standard										
Part No.	Dimensions (mm)							Basic Loads (KN)		N.W. (kg)
	d1	D	L	d	B	C	h	Cr	Cor	
UK205	20	52	35	25	24	17	4.2	12	6.7	0.24
UK206	25	62	38	30	27	19	4.8	16.7	9.6	0.4
UK207	30	72	43	35	30	22	5.4	22	13.1	0.53
UK208	35	80	46	40	33	23	5.9	28	17	0.69
UK209	40	85	50	45	33	23	6.1	28.1	17.5	0.77
UK210	45	90	55	50	33	23	6.5	30.1	19.9	0.93
UK211	50	100	59	55	35	26	7.1	37.2	25.1	1.25
UK212	55	110	62	60	35	26	7.6	41	28.3	1.56
UK213	60	120	65	65	36	27	8.5	49.2	34.4	1.95
UK215	65	130	73	75	39	30	9	56.8	42.6	2.59
UK216	70	140	78	80	42	32	9	62.4	45.6	3.26
UK217	75	150	82	85	46	34	10	71.8	55	3.93
UK218	80	160	86	90	49	36	10.5	82.6	61.5	4.68
UK208TRL	35	80	46	40	33	23	5.9	28	17	0.69
UK211TRL	50	100	59	55	35	26	7.1	37.2	25.1	1.25

Triple Lip										
Part No.	Dimensions (mm)							Basic Loads (KN)		N.W. (kg)
	d1	D	L	d	B	C	h	Cr	Cor	
UK212TRL	55	110	62	60	35	26	7.6	41	28.3	1.56
UK213TRL	60	120	65	65	36	27	8.5	49.2	34.4	1.95