

## High Speed Pulleys - Single Row Bearings

They are used in heavy duty applications where loads and speeds are greater than required for unground bearings-usually over 2000 RPM. Many are used on modern combines and hay baling equipment. Aetna V-belt idlers are available with single row bearings with a bore size to clear 1/2 and 5/8 bolts. Aetna belt idlers are generally used as tensioners or direction changers. Permanently lubricated and sealed against grime and dirt. Fit into existing design with little or no engineering changes or are readily adapted to new designs.

### ADVANTAGES

- Heavy gauge precision formed steel with double row of steel rivets with strengthening rib
- Precision bearing for high capacity, lubricated and sealed for life
- Solid steel bushing to provide proper mounting clearance
- "Weep" holes to prevent water build-up
- Basic radial load rating of precision bearing is 1,820 pounds

### Flat Flanged Idlers

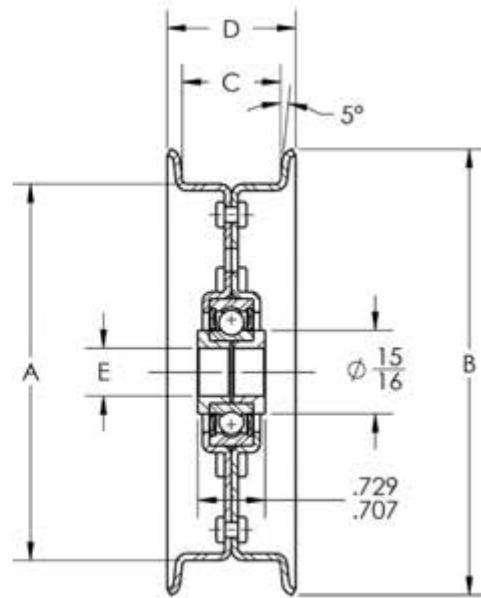
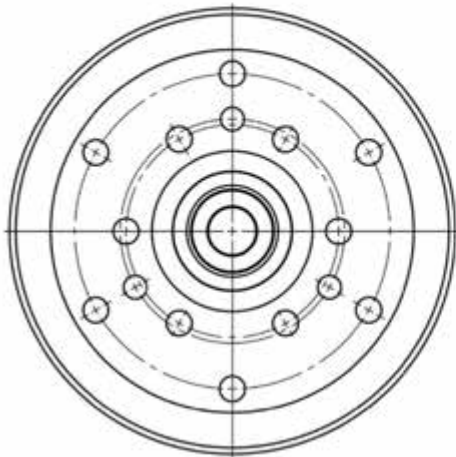

PART NO.	UNIT	A	B	C	D	E
F14026-B	Inch	5	5-3/4	1-5/8	2-1/16	.635/.640
	mm	127	146.06	41.275	52.387	16.129/16.256
F14416-A	Inch	5-1/2	6-1/4	1	1-7/16	.510/.515
	mm	139.7	158.75	25.4	36.512	12.954/13.081
F14416-B	Inch	5-1/2	6-1/4	1	1-7/16	.635/.640
	mm	139.7	158.75	25.4	36.512	16.129/16.256
F16416-B	Inch	8	9	1	1-7/16	.635/.640
	mm	203.2	228.6	25.4	36.512	16.129/16.256
F16424-B6*	Inch	8	9	1-1/2	1-15/16	.635/.640
	mm	203.2	228.6	38.1	49.212	16.129/16.256

## High Speed Pulleys - Double Row Bearings

They are used in heavy duty applications where loads and speeds are greater than required for unground bearings—usually over 2000 RPM. Many are used on modern combines. Aetna straight belt idlers for flat belts are available with double row bearings and bushed to clear 1/2 , 5/8 and 3/4 bolts. Aetna belt idlers are generally used as tensioners or direction changers. Permanently lubricated and sealed against grime and dirt. Fit into existing design with little or no engineering changes or are readily adapted to new designs.

### ADVANTAGES

- Heavy gauge precision formed steel with annular strengthening rib.
- Double row of steel rivets
- Double row lubricated for life sealed precision angular contact bearing for higher capacity and rigidity
- Steel bushing to provide proper bolt clamping and centering
- Basic radial load rating of precision bearing is 3,340 pounds

### Flat Flanged Idlers

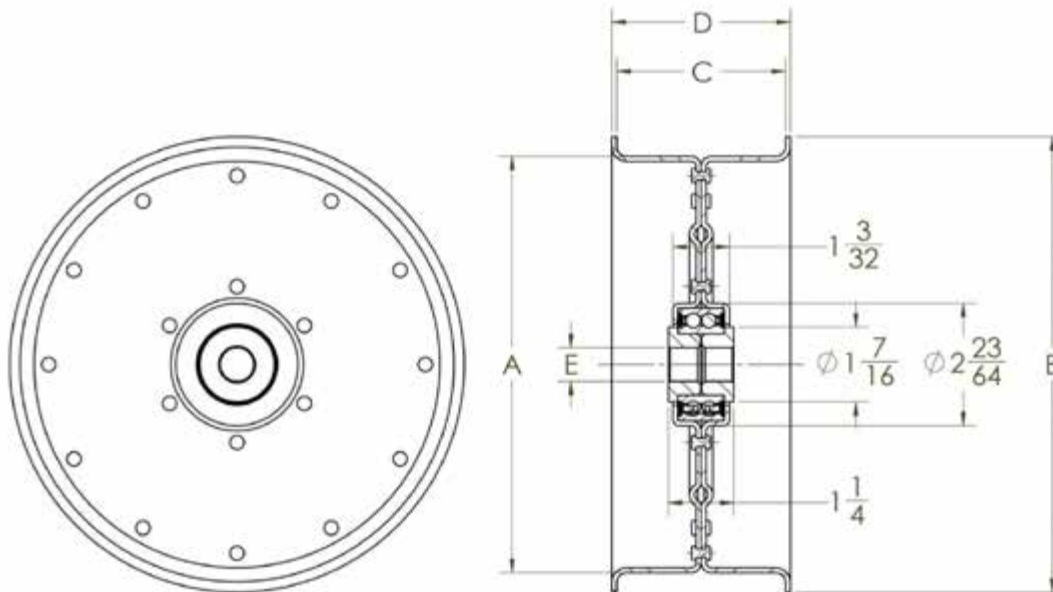

PART NO.	UNIT	A	B	C	D	E
F26448-B6**	Inch	8	8-3/4	3	3-3/16	.643/.649
	mm	203.2	222.25	76.2	80.962	16.332/16.484
F26452-B9**	Inch	8	8-3/4	3-1/4	3-7/16	.643/.649
	mm	203.2	222.25	82.55	87.312	16.332/16.484

\*\*Zinc Plated Yellow Hexavalent Chromium Finish

# Flat Face Idler Pulleys (High Speed)

BOOK 2: BELTS &amp; PULLEYS CONTENTS

## High Speed Pulleys - Double Row Bearings

They are used in heavy duty applications where loads and speeds are greater than required for unground bearings-usually over 2000 RPM. Many are used on modern combines. Aetna straight belt idlers for flat belts are available with double row bearings and bushed to clear 1/2, 5/8 and 3/4 bolts. Aetna belt idlers are generally used as tensioners or direction changers. Permanently lubricated and sealed against grime and dirt. Fit into existing design with little or no engineering changes or are readily adapted to new designs.

### ADVANTAGES

- Heavy gauge precision formed steel with annular strengthening rib. Double row of steel rivets
- Double row lubricated for life sealed precision angular contact bearing for higher capacity and rigidity
- Steel bushing to provide proper bolt clamping and centering
- Basic radial load rating of precision bearing is 3,340 pounds

### Flat Face Idlers

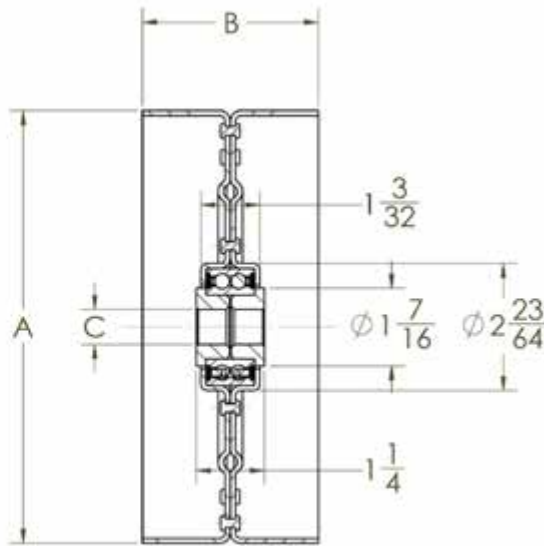
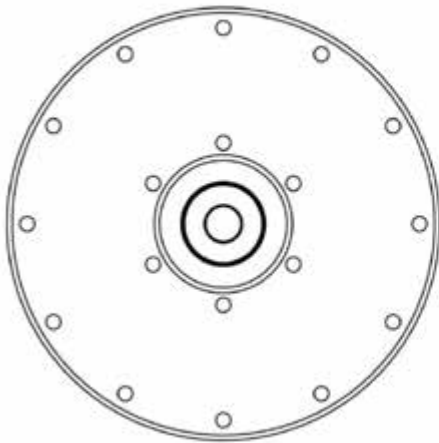

PART NO.	UNIT	A	B	C
S24032-A	Inch	5	2	.516/.522
	mm	127	50.8	13.0164/13.2588
S24032-B	Inch	5	2	.643/.649
	mm	127	50.8	16.3322/16.4846
S25252-A	Inch	6-1/2	3-1/4	.516/.522
	mm	165.1	82.55	13.0164/13.2588
S25252-C	Inch	6-1/2	3-1/4	.769/.775
	mm	165.1	82.55	19.5326/19.685
S26452-B6**	Inch	8	3-1/4	.643/.649
	mm	203.2	82.55	16.3322/16.4846
S28052-B	Inch	10	3-1/4	.643/.649
	mm	254	82.55	16.3322/16.4846

\*\*Zinc Plated Yellow Hexavalent Chromium Finish

2.5 IDLER PULLEYS